

# HEX NUT - METRIC

## 316 STAINLESS STEEL



Import



Precision  
Machined

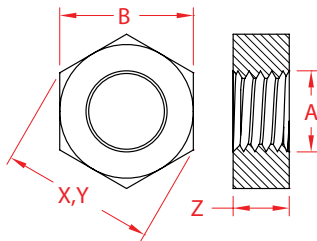

ITEM	A (size)	B (wrench)	THREAD	X (height)	Y (length)	Z (width)	WT (lb)	PACKAGING TYPE	EACH (qty)	INNER (qty)	CARTON (qty)	UPC
<b>RIGHT HAND, METRIC</b>												
S0303-MM05	5 MM	0.31" 5/16"	M5 x 0.8	0.35"	0.35"	0.15"	0.25/100	POLYBAG	1	5	100	791506038498
S0303-MM06	6 MM	0.38" 3/8"	M6 x 1.0	0.43"	0.43"	0.19"	0.45/100	POLYBAG	1	5	100	791506038504
S0303-MM10	10 MM	0.65" 5/8"	M10 x 1.5	0.75"	0.75"	0.30"	2.0/100	POLYBAG	1	5	100	791506038511
S0303-MM12	12 MM	0.74" 3/4"	M12 x 1.75	0.84"	0.84"	0.38"	3.5/100	POLYBAG	1	5	100	791506038528
S0303-MM16	16 MM	0.93" 15/16"	M16 x 2.0	1.07"	1.07"	0.50"	8.0/100	POLYBAG	1	1	50	791506038535
S0303-MM20	20 MM	1.17" 1-3/16"	M20 x 2.5	1.32"	1.32"	0.61"	12.0/100	POLYBAG	1	1	50	791506038542

**NOTE:**  
**ALL DIMENSIONS ARE NOMINAL (+/- 3%) AND ARE SUBJECT TO CHANGE WITHOUT NOTICE.**